

IB5169

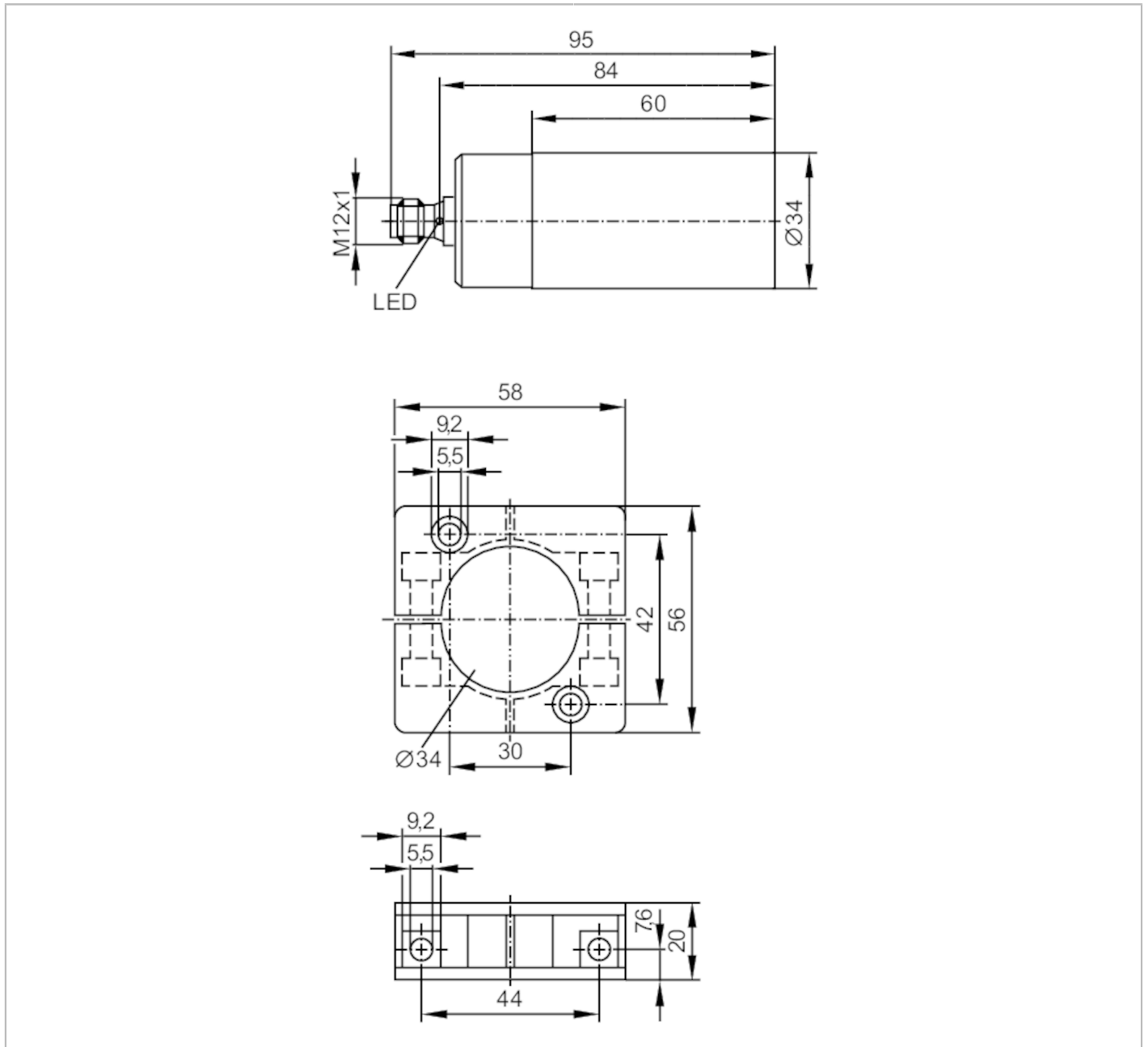

Inductive sensor

IB-2020-FRKG/US-104-IRF



Product characteristics

Electrical design	PNP/NPN
Output function	normally open / normally closed; (selectable)
Sensing range [mm]	20
Housing	cylindrical
Dimensions [mm]	Ø 34 / L = 95

Application

Special feature	Gold-plated contacts
-----------------	----------------------

Electrical data

Operating voltage [V]	10...36 DC
-----------------------	------------

IB5169



Inductive sensor

IB-2020-FRKG/US-104-IRF

Protection class	II	
Reverse polarity protection	yes	
Outputs		
Electrical design	PNP/NPN	
Output function	normally open / normally closed; (selectable)	
Max. voltage drop switching output DC [V]	4.6	
Minimum load current [mA]	4	
Max. leakage current [mA]	1	
Permanent current rating of switching output DC [mA]	250	
Switching frequency DC [Hz]	200	
Short-circuit protection	yes	
Overload protection	yes	
Detection zone		
Sensing range [mm]	20	
Real sensing range S_r [mm]	$20 \pm 10 \%$	
Operating distance [mm]	0...16.2	
Accuracy / deviations		
Correction factor	steel: 1 / stainless steel: 0.7 / brass: 0.5 / aluminium: 0.4 / copper: 0.3	
Hysteresis [% of S_r]	1...15	
Switch point drift [% of S_r]	-10...10	
Operating conditions		
Ambient temperature [°C]	-25...70	
Protection	IP 67	
Tests / approvals		
EMC	EN 60947-5-2	
MTTF [years]	1941	
Mechanical data		
Weight [g]	226	
Housing	cylindrical	
Mounting	non-flush mountable	
Dimensions [mm]	$\varnothing 34 / L = 95$	
Materials	housing: PBT; sensing face: PBT orange; clamp: PBT black	
Displays / operating elements		
Display	switching status	4 x 90° LED, yellow
Accessories		
Items supplied	Mounting clamps: 1	
Remarks		
Pack quantity	1 pcs.	

IB5169



Inductive sensor

IB-2020-FRKG/US-104-IRF

Electrical connection - plug

Connector: 1 x M12; coding: A; Locking: brass, anti-spatter; Contacts: gold-plated

